

**CNS 50 S, CNS 75 S, CNS 100 S, CNS 125 S,
CNS 150 S, CNS 175 S, CNS 200 S, CNS 250 S, CNS 300 S**

**CNS 50 U, CNS 75 U, CNS 100 U, CNS 125 U,
CNS 150 U, CNS 175 U, CNS 200 U, CNS 250 U, CNS 300 U**

Deutsch

Wand-Konvektor

Gebrauchs- und Montageanweisung

English

Wall mounted convector heater

Operation and installation instructions

Français

Convecteur mural

Notice d'installation et d'utilisation

Nederlands

Wand-convector

Gebruiks- en installatieaanwijzing

Español

Convector mural

Instrucciones de uso y montaje

Polska

Konwektory

Instrukcja użytkowania i montażu

Česky

Nástěnný konvektor

Návod k použití a k montáži

Русский

Конвектор

Инструкция по монтажу и эксплуатации

한국어

벽걸이 컨벡터 라디에이터

작동 및 설치 설명서

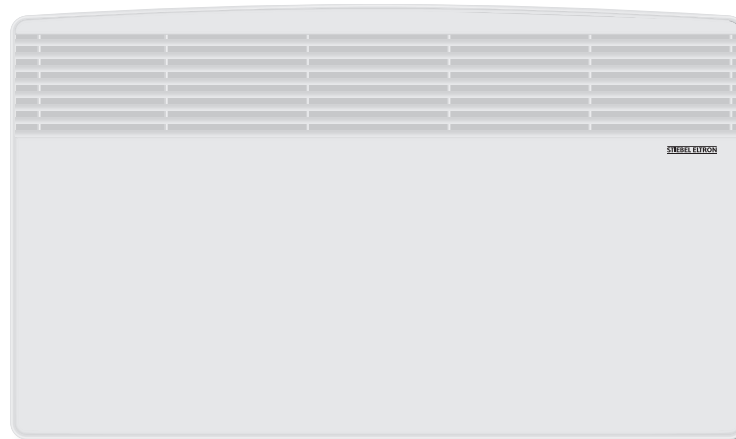

Inhaltsverzeichnis

Deutsch	Seite 4 - 7
1. Gebrauchsanweisung	4 - 5
1.1 Gerätebeschreibung	
1.2 Bedienung	
1.3 Sicherheitshinweise	
1.4 Pflege und Wartung	
Was tun wenn ...?	5
2. Montageanweisung	5 - 6
2.1 Geräteaufbau	
2.2 Vorschriften und Bestimmungen	
2.3 Montage	
2.4 Elektrischer Anschluss	
2.5 Übergabe	
Technische Daten	6
Umwelt und Recycling	6
Kundendienst und Garantie	7

Table of contents

English	page 8 - 10
1. Operating instructions	8 - 9
1.1 Description	
1.2 Operation	
1.3 Safety notes	
1.4 Care and maintenance	
What to do if ...?	9
2. Installation instructions	9 - 10
2.1 Structure of unit	
2.2 Provisions and specifications	
2.3 Installation	
2.4 Electrical connection	
2.5 Handover	
Technical data	10
Environment and recycling	10
Guarantee	10

Table des matières

Français	page 11 - 13
1. Notice d'utilisation	11 - 12
1.1 Description de l'appareil	
1.2 Fonctionnement	
1.3 Consignes de sécurité	
1.4 Entretien et maintenance	
Que faire quand ...?	12
2. Instructions de montage	12
2.1 Composition de l'appareil	
2.2 Normes et spécifications	
2.3 Montage	
2.4 Raccordement électrique	
2.5 Remise de l'appareil	
Caractéristique techniques	13
Environment et recyclage	13
Garantie	13

Inhoudsoverzicht

Nederlands	bladzijde 14 - 16
1. Gebruiksaanwijzing	14 - 15
1.1 Toestelbeschrijving	
1.2 Bediening	
1.3 Veiligheidsaanwijzingen	
1.4 Verzorging en onderhoud	
Wat te doen als ...?	15
2. Montageaanwijzing	15 - 16
2.1 Opbouw van het toestel	
2.2 Voorschriften en bepalingen	
2.3 Montage	
2.4 Elektrische aansluiting	
2.5 Overdracht	
Technische gegevens	16
Milieu en recycling	16
Garantie	16

Índice

Español	Páginas 17 - 19
1. Instrucciones de uso	17 - 18
1.1 Descripción del aparato	
1.2 Manejo	
1.3 Indicaciones de seguridad	
1.4 Cuidados y mantenimiento	
¿Qué hacer cuando ...?	18
2. Instrucciones de montaje	18 - 19
2.1 Componentes del aparato	
2.2 Reglamentos e instrucciones	
2.3 Montaje	
2.4 Conexión eléctrica	
2.5 Entrega	
Datos técnicos	19
Medio ambiente y reciclaje	19
Garantía	19

Spis treści

Polski	strona 20 - 22
1. Instrukcja obsługi	20 - 21
1.1 Opis urządzenia	
1.2 Obsługa	
1.3 Wskazówki dotyczące bezpieczeństwa	
1.4 Czyszczenie i konserwacja	
Co robić, gdy ...?	21
2. Instrukcja montażu	21 - 22
2.1 Budowa urządzenia	
2.2 Przepisy i zalecenia	
2.3 Montaż urządzenia	
2.4 Podłączenie elektryczne	
2.5 Przekazanie Użytkownikowi	
Dane techniczne	22
Środowisko naturalne i recycling	22
Gwarancja	22

Obsah

Česky	strana 23 - 25
1. Návod k obsluze	23 - 24
1.1 Popis přístroje	
1.2 Obsluha	
1.3 Bezpečnostní pokyny	
1.4 Ošetřování a údržba	
Co dělat, když ...?	24
2. Instrukce k montáži	24 - 25
2.1 Konstrukce přístroje	
2.2 Předpisy a ustanovení	
2.3 Montáž	
2.4 Elektrická přípojka	
2.5 Předání přístroje	
Technická data	25
Ekologie a recyklace	25
Záruční podmínky	25

Содержание

Русский	Страница 26 - 28
1. Инструкция по эксплуатации	26
1.1 Описание прибора	
1.2 Обслуживание	
1.3 Указания по безопасности	
1.4 Уход и техническое обслуживание	
Что делать, если ...?	27
2. Инструкция по монтажу	27
2.1 Составляющие прибора	
2.2 Указания по безопасности	
2.3 Монтаж	
2.4 Электрическое подключение	
2.5 Сдача в эксплуатацию	
Технические характеристики	28
Окружающая среда и вторсырьё	28
Гарантия	28

목차

한국어	페이지 29-31
1. 사용 설명서	29 - 30
1.1 상세설명서	
1.2 사용	
1.3 설치 시 주의사항	
1.4 관리 및 유지	
이럴 땐 어떻게 해야 하나요...?	30
2. 설치 설명서	30 - 31
2.1 제품 구조	
2.2 설치 시 주의사항	
2.3 설치	
2.4 전기 연결	
2.5 의무사항	
기술정보	30
환경과 재활용	30
보증	30

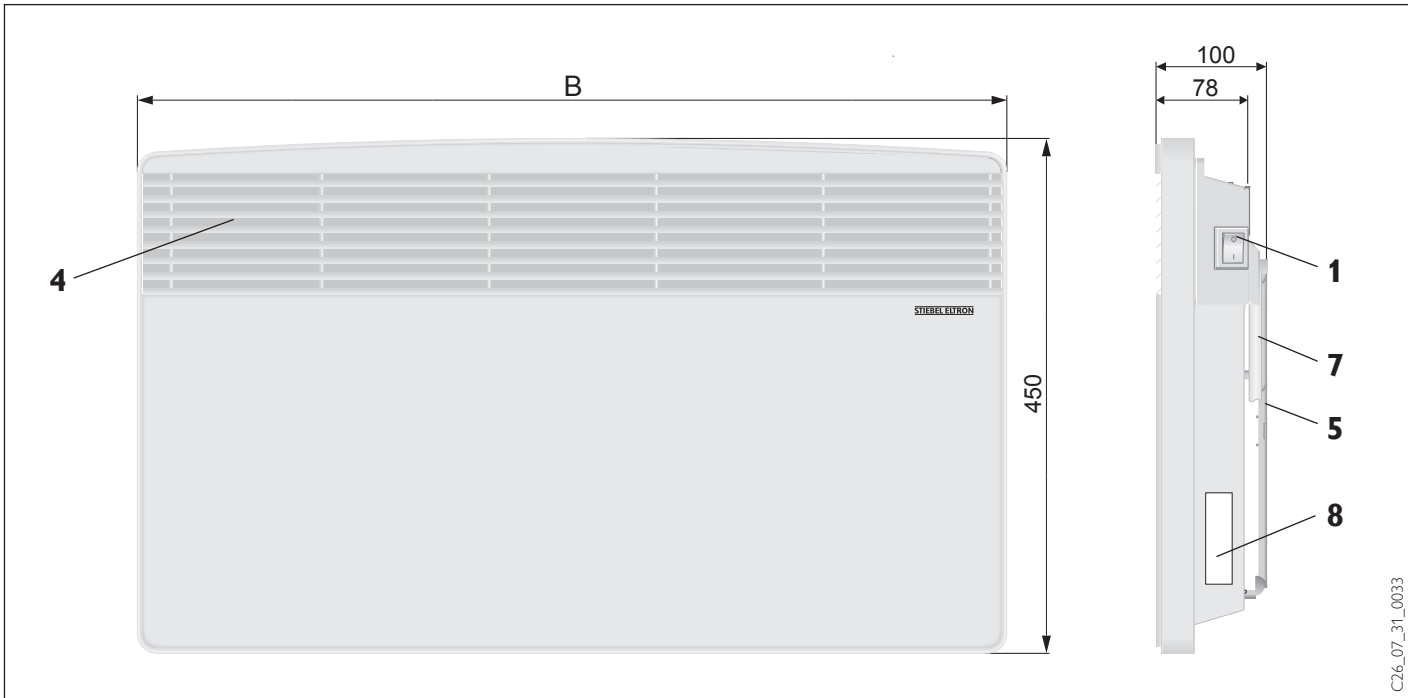

C26_07_31_0033

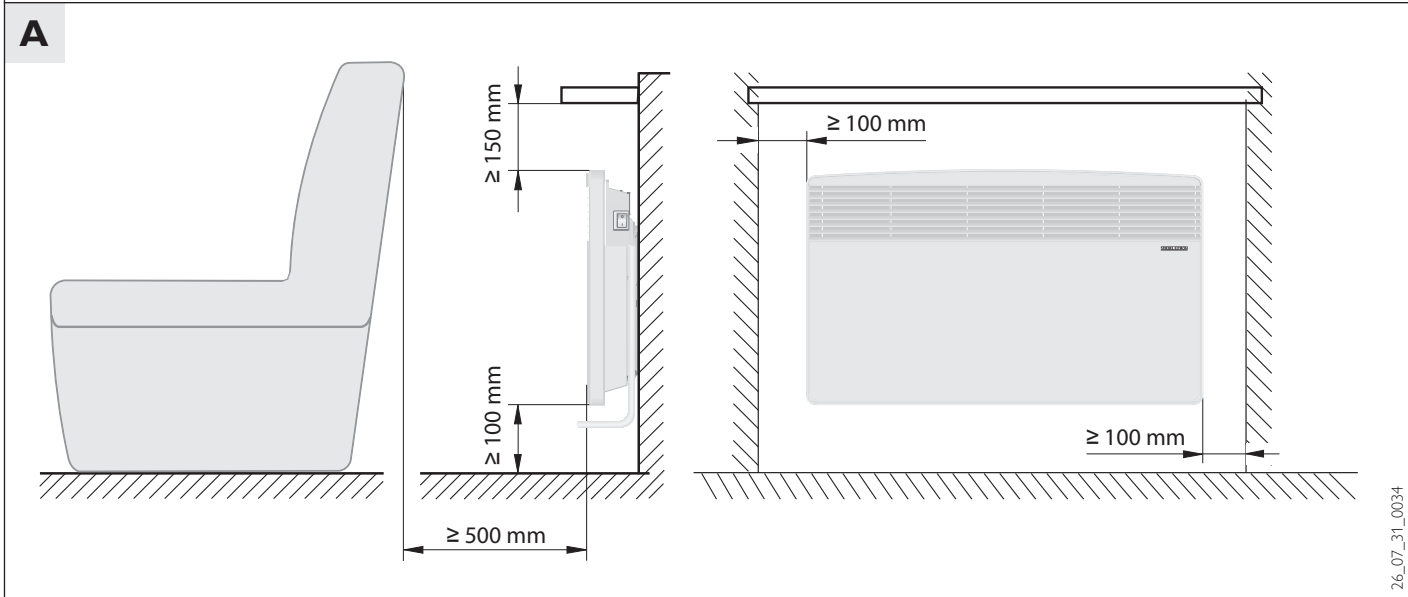

26_07_31_0034

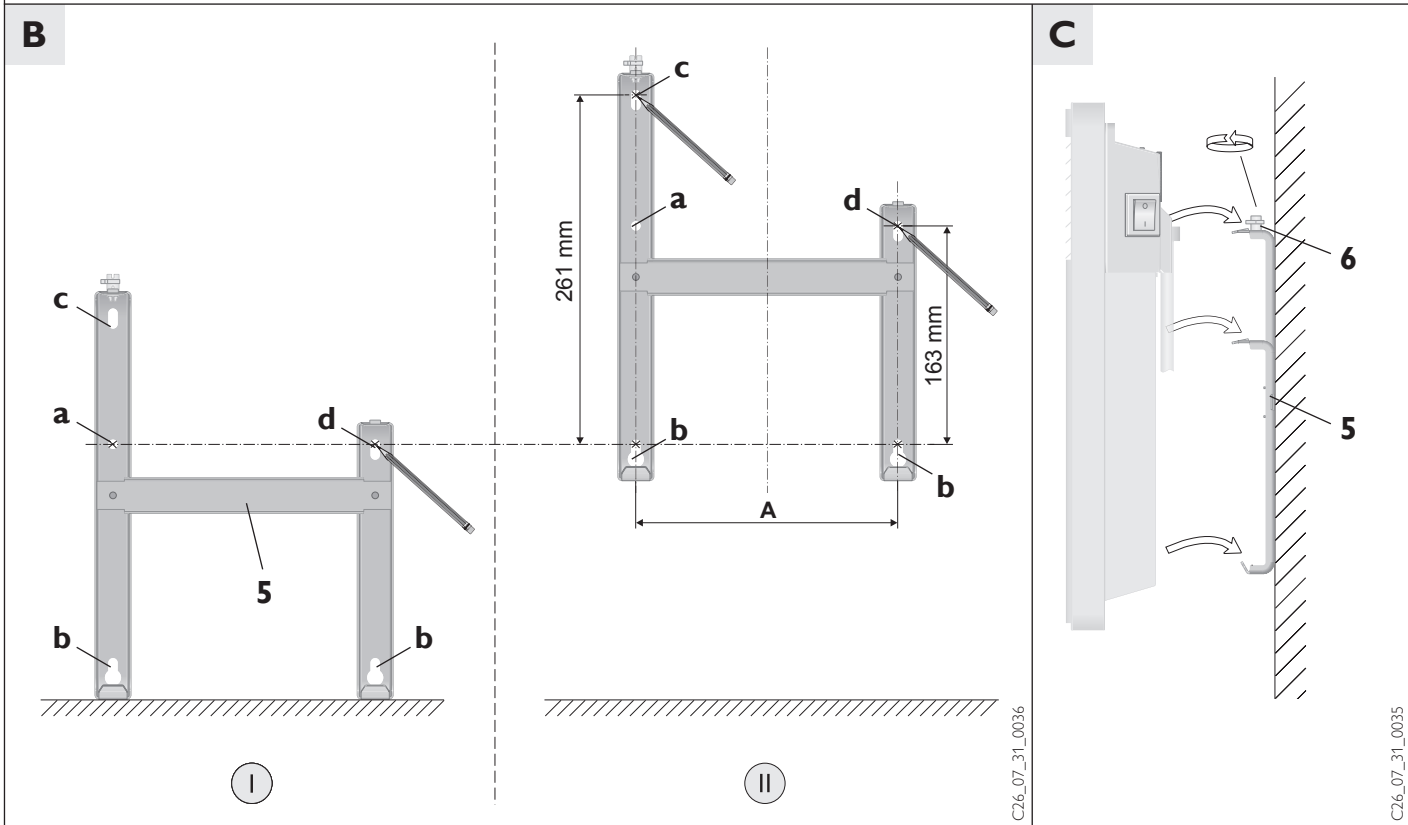

C26_07_31_0036

C26_07_31_0035



1 Operation instructions for the user and the professional

Important features in brief

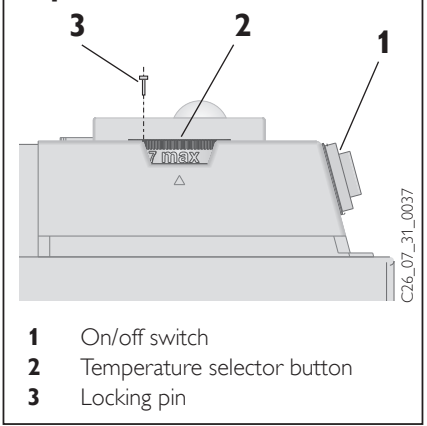

Use of electrical equipment in principle requires care to exclude any potential risks from fire, electrical shock or injury. Therefore the unit should only be used as described in these instructions, where any use outside the manufacturer's recommendations can lead to damage or injury.

The correct match between the heat requirement of the room and the heating power of the unit must be observed.

Before use of the unit, read the entire instructions and follow the information given on proper handling of the unit.



These instructions should be kept carefully and handed to any subsequent user of the unit. Please show them to the engineer performing any repair work.

1.1 Description

The CNS is an electric direct heater exclusively for wall installation. It is suitable e.g. for heating a bathroom or as transitional or additional heating for small rooms such as hobby rooms or guest rooms.

Series CNS-S

After wall mounting and electrical connection via a plug and socket, the unit is ready for use.

Series CNS-U

After wall mounting and electrical connection via a fixed connection through a junction box (note national regulations), the unit is ready for use.

Function

The air in the convector is heated by a heating element and emerges by natural convection at the top through the air outlet grille (4). The openings in the underside of the unit provide it with cool room air.

Safety device

The convector has a protective thermostat (STR) which switches the appliance off on

overheating. After eliminating the cause (e.g. covered air outlet or inlet opening), after a cooling down period of a few minutes the unit resumes operation.

1.2 Operation

The convector is switched on and off via the switch (1) on the right-hand side. The desired room temperature is set via the temperature selector (2) anywhere between around +6°C and +30 °C. As soon as the set room temperature has been reached, it is maintained constantly by intermittent heating (the heating power of the unit must correspond at least to the heat requirements of the room).

If several heaters are fitted in a room, the temperature setting on each unit may vary. To avoid excessive energy consumption with the windows open, the unit should be switched off during ventilation at the switch (1).

Frost protection

If the unit is used as a frost guard, set the temperature selector (2) to the far right stop (*). In this position the thermostat switches the heating on automatically if the room temperature falls to around +6°C.

Limiting the thermostat

Using the two pins on the back of the switch housing (3), the thermostat can be fixed in a particular setting.

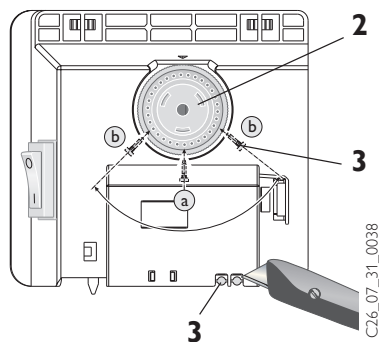

To fix a desired temperature, push pin a into the hole opposite.

To limit the temperature adjustment range, set the minimum and maximum values on the selector knob and mark these by inserting pin b into the opposite, slightly offset hole each time.

1.2.1 External room thermostat

If necessary the unit can be operated with a commercial external room thermostat. The temperature selector (2) must be turned to the right stop (MAX). The room thermostat should be located as far as possible from the unit and at least 1.5 m high.

1.2.2 Shutting Down

To shut down the unit, move the switch to the OFF position and remove the mains plug from the wall socket (do not pull out the plug using the lead).

1.3 Safety notes



The unit should not be operated

- in rooms at risk of explosion or fire from chemicals, dust, gas or vapour,
- in the immediate vicinity of pipes or containers which transport or contain flammable or explosive substances,
- if the minimum distances from adjacent object surfaces are not observed.

- Installation (electrical installation), first operation and maintenance of this unit may only be performed by an accredited expert according to these instructions.
- The unit must not be operated if in the same room work is performed such as floor laying, grinding, sealing, cleaning with petrol and care (spray, beeswax) and similar.
- The housing surfaces of the unit and the emerging air are hot during operation (over 80 °C).

Risk of burns!

Keep small children away from the unit.

- Do not place objects on the unit, lean objects against it or store anything between the heater and the wall (e.g. drying washing).

Also do not place in the immediate vicinity of the unit any flammable, combustible or heat-insulating objects or substances such as laundry, blankets, newspapers, containers of beeswax or petrol, spray cans or similar. **Risk of explosion!**



To prevent overheating of the unit, it must not be covered.

- **A** For objects of all types e.g. furniture, curtains, hangings or textiles or other flammable or non-flammable materials, the following minimum distances from the unit must be observed:

To the air outlet grille	⇒	500 mm
To the sides	⇒	100 mm
To the top	⇒	150 mm
To the underside	⇒	100 mm
To the back wall	⇒	26 mm

Hot air must be able to escape unobstructed.

- The unit may not be used as a freestanding unit.
- Do not stand on the unit.
- No changes may be made to the unit.
- The unit should never be left in operation accidentally.

- Special care is required if the unit is used in the presence of children, the infirm or animals. Risk of injury!
- If part of the unit is damaged, if the unit has fallen off or is malfunctioning, do not operate.
- In case the power mains supply is damaged, it must be replaced by the manufacturer, the customer service of the manufacturer or an authorized and qualified person. Mandatory for hazard prevention.

1.4 Care and maintenance

If the unit housing shows a slight brown discoloration it should be cleaned as soon as possible with a damp warm cloth: When the appliance is cold it can be cleaned with normal cleaning agents. Avoid scouring or aggressive cleaning agents. Moisture must not penetrate the unit. Do not spray cleaning spray into the air slots.

For regular maintenance we recommend checking the control and adjustment elements. At the latest 10 years after first use, the safety, control and adjustment elements should be checked by an expert.

What to do if ...?

• the unit does not get hot?

Check that ...
... the ON/OFF switch is turned on.
... in your fuse box, the corresponding fuse is intact or whether the breaker has tripped.

Eliminate cause!

If the heater still does not warm up, **call customer service!**

• the unit switches itself off?

Check whether it is covered, so it could have overheated (e.g. covered air outlet or inlet opening).

Eliminate cause!

If it does not warm up again after a few minutes' cooling down period, **call customer service!**

• customer service is called?

Read the **type** (Typ) and **number** (Nr.) from the rating plate **(8)** on the unit and tell customer service!

STIEBEL ELTRON
Typ: CNS
Nr.: - -



2 Installation instructions for the professional

This unit may only be erected and electrically connected by a specialist following the installation instructions.

First remove the packaging and check accessories and any enclosures, ensure that no accessories remain in the packaging material.

2.1 Structure of unit

- 4 Air outlet grid
- 5 Wall bracket
- 6 Closing bolt
- 7 Mains connection cable
- 8 Rating plate

2.2 Provisions and specification



The unit should not be operated

- in rooms at risk of explosion or fire from chemicals, dust, gas or vapour,
- in the immediate vicinity of pipes or containers which transport or contain flammable or explosive substances,
- if the minimum distances from adjacent object surfaces are not observed.

In workshops or other rooms in which exhaust gases, oil or petrol vapours etc. occur or where solvents and chemicals are used, persistent odour problems and where applicable contamination can occur.

- The unit may only be fitted to a vertical wall, temperature-resistant up to at least 80 °C.
- Minimum distances from adjacent object surfaces must be observed.
- All electrical connection and installation work must be performed to VDE regulations (0100), the regulations of a competent utility company and the corresponding national and regional regulations.
- The unit must not be mounted directly below a wall socket.
- If the unit is permanently connected to an AC network (junction box) an isolation distance of at least 3mm is required on all poles for isolation from the network. For this, circuit breakers, LS switches, fuses etc. can be used. Installation with permanent connection cables is not permitted.
- The rating plate must be observed. The rated voltage must correspond to the nominal voltage.
- On installation of the heater in rooms with a bath and/or shower, the protection area to VDE 0100 part 701 as specified on the unit rating plate must be observed.
- The unit must be mounted such that the switch and control units are out of reach of a person in the bath or shower.
- The mains connection cable may only be replaced with original Stiebel Eltron spare parts by experts.

2.3 Installation

2.3.1 Installation of wall bracket **B**

The wall bracket should be used as a template for fixing the appliance to the wall. It also helps to keep the necessary ground clearance. To attach the unit proceed as follows:

- **I** Place the wall bracket **(5)** holding the centre point horizontally on the ground and mark the holes **a** and **d** on the assembly wall;
- **II** Raise the wall bracket so that the holes **b** in the wall bracket coincide with the marks just made on the assembly wall;
- Mark holes **c** and **d** on the wall bracket on the assembly wall;
- At all four markings drill holes and attach the wall bracket to the wall using suitable fixing materials (wall plugs and screws) dependig on the type of wall. The vertical slots allow adjustment for an offset in the fixing holes.

2.3.2 Unit installation **C**

The convector is mounted by attaching the slots on the rear simultaneously to the four tabs of the wall bracket pressing down to lock. The closing bolt **(6)** of the wall bracket is then turned clockwise to the stop, locking the fixing. To remove the convector, unscrew the locking bolt and lift the unit slightly, pulling it forwards and out of the bracket.

2.4 Electrical connection

The required electrical connection is AC 230V.

For fixed connection, an earth socket or junction box should be installed at a distance of at least 100 mm to the side of the heater.

2.5 Handover

Explain to the user how the unit functions. Draw his attention in particular to the safety instructions. Give the user these operating and usage instructions.

Technical data

Type		CNS 50 S	CNS 75 S	CNS 100 S	CNS 125 S	CNS 150 S	CNS 175 S	CNS 200 S	CNS 250 S	CNS 300 S
		CNS 50 U	CNS 75 U	CNS 100 U	CNS 125 U	CNS 150 U	CNS 175 U	CNS 200 U	CNS 250 U	CNS 300 U
Height	mm	450								
Width	mm	370	445	445	590	590	740	740	890	1040
Depth with wall bracket	mm	78								
		100								
Dimension A	mm	121	195	195	343	343	491	491	639	787
Weight	kg	3,0	4,2	4,2	5,6	5,6	7,0	7,0	8,4	9,8
Connection		1/N ~ 230 V								
Power	kW	0,5	0,75	1,0	1,25	1,5	1,75	2,0	2,5	3,0
Temperature adjustment range	°C	approx. 6 to 30								
Frost protection	°C	approx. 6								
Protection class		II								
Protection mode		IP 24, splash water protected								
Approval		see unit rating palte								



Environment and recycling

Recycling of obsolete appliances



Appliances with this label must not be disposed off with the general waste. They must be collected separately and disposed off according to local regulations.



Guarantee

For guarantees please refer to the respective terms and conditions of supply for your country.



The installation, electrical connection and first operation of this appliance should be carried out by a qualified installer.

The company does not accept liability for failure of any goods supplied which accordance with the manufacturer's instructions.

Adressen und Kontakte**www.stiebel-eltron.com****Zentrale Holzminden****Stiebel Eltron GmbH & Co. KG**

Dr.-Stiebel-Str. 37603 Holzminden
 Telefon 05531/702-0
 Fax Zentrale 05531/702-480
 E-Mail info@stiebel-eltron.com
 Internet www.stiebel-eltron.com

Stiebel Eltron International GmbH

Dr.-Stiebel-Str. 37603 Holzminden
 Telefon 05531/702-0
 Fax 05531/702-479
 E-Mail info@stiebel-eltron.com
 Internet www.stiebel-eltron.com

Unseren zentralen Service erreichen Sie unter 0 180 3...

... in der Zeit von:

Montag bis Donnerstag 7¹⁵ bis 18⁰⁰ Uhr
Freitag 7¹⁵ bis 17⁰⁰ Uhr

Verkauf**Telefon 0 180 3 - 70 20 10****Telefax 0 180 3 / 70 20 15****E-Mail: info-center@stiebel-eltron.com****Kundendienst****Telefon 0 180 3 - 70 20 20****Telefax 0 180 3 / 70 20 25****E-Mail: kundendienst@stiebel-eltron.com****Ersatzteil-Verkauf****Telefon 0 180 3 - 70 20 30****Telefax 0 180 3 / 70 20 35****E-Mail: ersatzteile@stiebel-eltron.com**

0,09 €/min (Stand: 01/06)

Stiebel Eltron Vertriebszentren**Dortmund**

Oespel (Indupark) 44149 Dortmund
 Brennaborstr.19
 Telefon 02 31/96 50 22-10
 E-Mail: dortmund@stiebel-eltron.com

Frankfurt

Rudolf-Diesel-Str.18 65760 Eschborn
 Telefon 0 61 73/6 02-10
 E-Mail: frankfurt@stiebel-eltron.com

Hamburg

Georg-Heyken-Straße 4a 21147 Hamburg
 Telefon 0 40/75 20 18-10
 E-Mail: hamburg@stiebel-eltron.com

Köln

Ossendorf
 Mathias-Brüggen-Str. 132 50829 Köln
 Telefon 02 21/5 97 71-10
 E-Mail: koeln@stiebel-eltron.com

Leipzig

Airport Gewerbepark/Glesien
 Ikarusstr. 10 04435 Schkeuditz-Glesien
 Telefon 03 42 07/7 55-10
 E-Mail: leipzig@stiebel-eltron.com

München

Hainbuchenring 4 82061 Neuried
 Telefon 0 89/89 91 56-10
 E-Mail: muenchen@stiebel-eltron.com

Stuttgart

Weilimdorf
 Motorstr. 39 70499 Stuttgart
 Telefon 07 11/9 88 67-10
 E-Mail: stuttgart@stiebel-eltron.com

Tochtergesellschaften und Vertriebszentren Europa und Übersee**Belgique**

Stiebel Eltron Sprl/Pvba
 Rue Mitoyenne 897 B-4840 Welkenraedt
 ☎ 0 87-88 14 65 Fax 0 87-88 15 97
 E-Mail info@stiebel-eltron.be
 Internet www.stiebel-eltron.be

Česká republika

Stiebel Eltron spol. s r.o.
 K Hájm 946 ČZ-15500 Praha 5-Stodulky
 ☎ 2-511 16111 Fax 2-355 12122
 E-Mail info@stiebel-eltron.cz
 Internet www.stiebel-eltron.cz

France

Stiebel Eltron S.A.S.
 7-9, rue des Selliers
 B.P. 85107 F-57073 Metz-Cédex
 ☎ 03-87-74 3888 Fax 03-87-74 6826
 E-Mail info@stiebel-eltron.fr
 Internet www.stiebel-eltron.fr

Great Britain

Exclusive Distributor:
 Applied Energy Products Ltd.
 Morley Way GB-Peterborough PE2 9JJ
 ☎ 087 09-00 04 20 Fax 017 33-31 96 10
 E-Mail sales@applied-energy.com
 Internet www.applied-energy.com

Magyarország

Stiebel Eltron Kft.
 Pacsirtamező u. 41 H-1036 Budapest
 ☎ 012 50-6055 Fax 013 68-8097
 E-Mail info@stiebel-eltron.hu
 Internet www.stiebel-eltron.hu

Niederland

Stiebel Eltron Nederland B.V.
 Daviottenweg 36 NL-5202 CA's-Hertogenbosch
 Postbus 2020
 ☎ 073-6 23 00 00 Fax 073-6 23 11 41
 E-Mail stiebel@stiebel-eltron.nl
 Internet www.stiebel-eltron.nl

Österreich

Stiebel Eltron Ges.m.b.H.
 Eferdinger Str. 73 A-4600 Wels
 ☎ 072 42-47367-0 Fax 07242-47367-42
 E-Mail info@stiebel-eltron.at
 Internet www.stiebel-eltron.at

Polska

Stiebel Eltron sp.z. o.o.
 ul. Instalatorów 9 PL-02-237 Warszawa
 ☎ 022-8 46 48 20 Fax 022-8 46 67 03
 E-Mail stiebel@stiebel-eltron.com.pl
 Internet www.stiebel-eltron.com.pl

Sverige

Stiebel Eltron AB
 Friggagatan 5 SE-641 37 Katrineholm
 ☎ 0150-48 7900 Fax 0150-48 7901
 E-Mail info@stiebel-eltron.se
 Internet www.stiebel-eltron.se

Schweiz

Stiebel Eltron AG
 Netzbodenstr.23 c CH-4133 Pratteln
 ☎ 061-8 16 93 33 Fax 061-8 16 93 44
 E-Mail info@stiebel-eltron.ch
 Internet www.stiebel-eltron.com

Thailand

Stiebel Eltron Ltd.
 469 Building 77, Bond Street
 Tambon Bangpood Nonthaburi 11120
 Ampur Pakkred
 ☎ 02-960 1602-4 Fax 02-960 1605
 E-Mail stiebel@loxinfo.co.th
 Internet www.stiebeleltronasia.com

USA

Stiebel Eltron Inc.
 17 West Street West Hatfield MA 01088
 ☎ 04 13-247-3380 Fax 0413-247-3369
 E-Mail info@stiebel-eltron-usa.com
 Internet www.stiebel-eltron-usa.com